



26 Homespring House Pittville Circus Road, Cheltenham, GL52

By Auction £50,000



1



1



1







# 26 Homespring House Pittville Circus Road

## Cheltenham, GL52 2QB

- FOR SALE BY AUCTION
- LIFT
- LIBRARY ON SITE
- RESIDENTS LOUNGE
- OVER 60'S RETIREMENT
- 24 HOUR EMERGENCY SYSTEM
- LAUNDRY ROOM ON SITE
- GUEST SUITES

HMT Sales & Lettings are delighted to offer for sale, via auction, this one bedroom retirement (over 60's) first floor apartment located close to Pittville Park.

As you enter the apartment, there is a long Entrance Hall with an impressive double Bedroom opposite. Further down the hallway is the Shower Room consisting of toilet, basin and large shower. At the end of the Hallway is the large Lounge Diner with modern Kitchen located just off it. In the Kitchen there is an integrated Dishwasher along with an Electric Oven, Hob and Extractor fan. The property is flooded with natural light that displays views of natural surrounding giving you greenery, yet close to the Town Centre. The apartment is warmed with electric heating and outside, one parking space is allocated to each resident. Lift are available inside to ease any mobility concerns.

There is a Resident Lounge where you can enjoy time with the other residents along with a small library in case your wanted to sit and enjoy a book. There are two guest suites that can be hired for visitors and a laundry room for you to do your washing.

Lease length remaining: 65 years  
Service Charge per 6 month: £870.28  
Ground Rent per 6 month: £219.08

Agent Notes: Enquiries and Viewings are to be booked via HMT Sales & Lettings on 01242 521322. If interested, your details are then shared with Pattinson Auctions where you can make an offer.

By Auction £50,000







### Directions

Leaving the Cheltenham Town Centre, head along the A4019 past The Brewery on your right hand side. Turn left onto Portland Street and follow the one way road to the right onto Prestbury Road. At the roundabout, turn right onto Pittville Circus Road and continue along there. Turn left into a private road for Homespring House.







Floor Plans

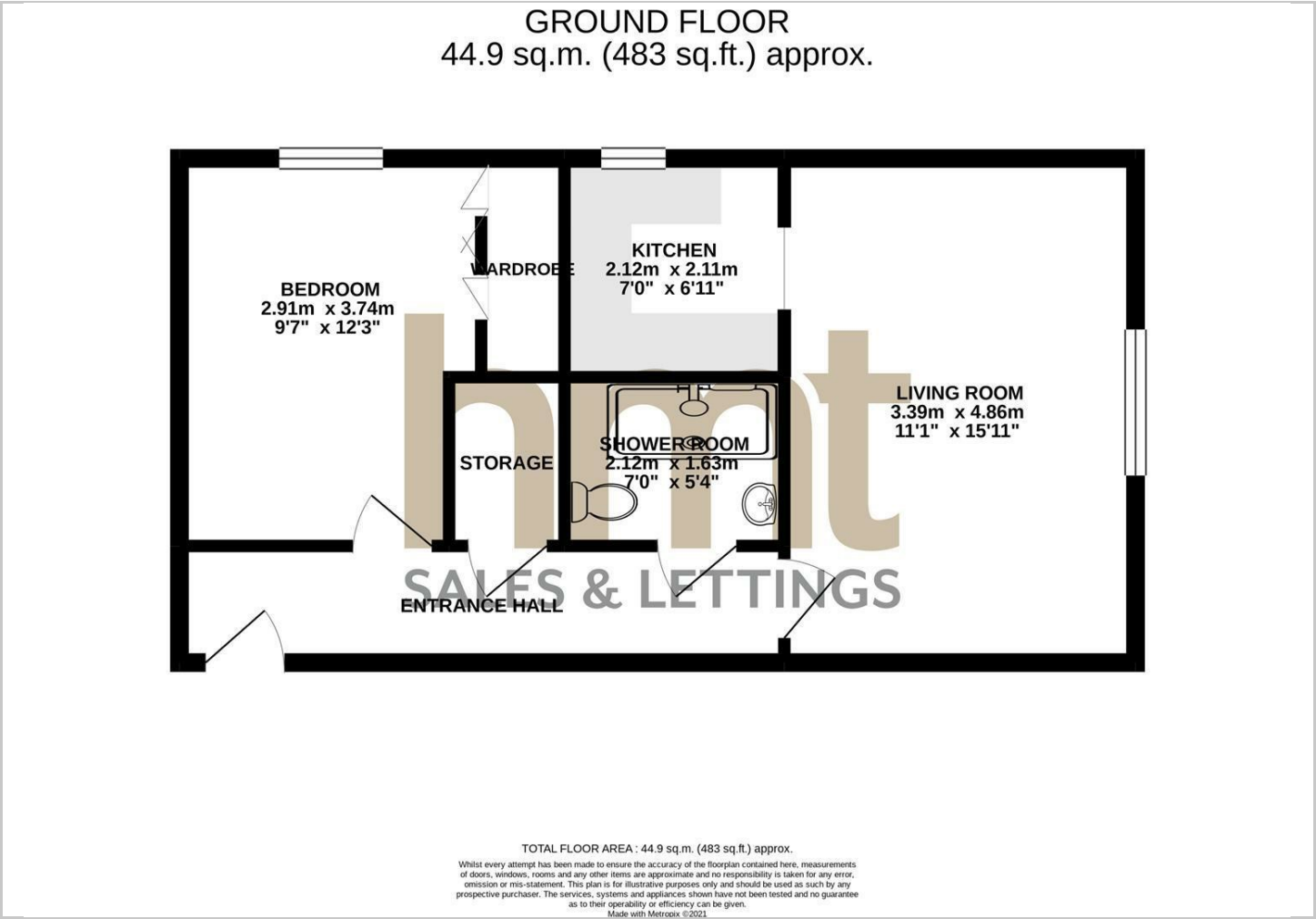

Viewing

Please contact our HMT Office on 01242 521322 if you wish to arrange a viewing appointment for this property or require further information.

The particulars are set out as a general outline only for the guidance of intended purchasers or lessees, and do not constitute, any part of a contract. Nothing in these particulars shall be deemed to be a statement that the property is in good structural condition or otherwise nor that any of the services, appliances, equipment or facilities are in good working order. Purchasers should satisfy themselves of this prior to purchasing.

2 Crescent Terrace, Cheltenham, Gloucestershire, GL50 3PE  
Tel: 01242 521322 Email: info@hmt.co.uk www.hmt.co.uk

Location Map



Energy Performance Graph

